

Westview 3

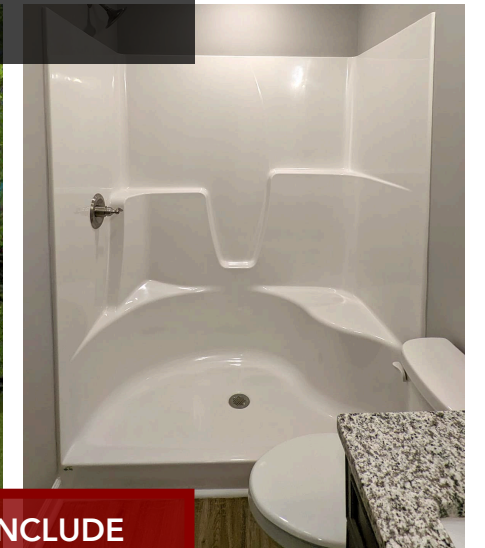

DISCLAIMER: IMAGES AND RENDERINGS MAY INCLUDE UPGRADES THAT ARE NOT INCLUDED IN STANDARD PRICES.



Westview 3, 1624 Sq Ft +/-, 3 bedroom 2 bath, 146 Sq Ft +/- Covered Wood Porch

***Images and renderings may vary from base pricing.

***Land improvements such as septic, well, driveway, and sidewalk are not included in standard pricing.

***5/12 roof pitch, wood front porch, and MDF cabinet construction is standard. Master shower requires shower curtain, no door included.

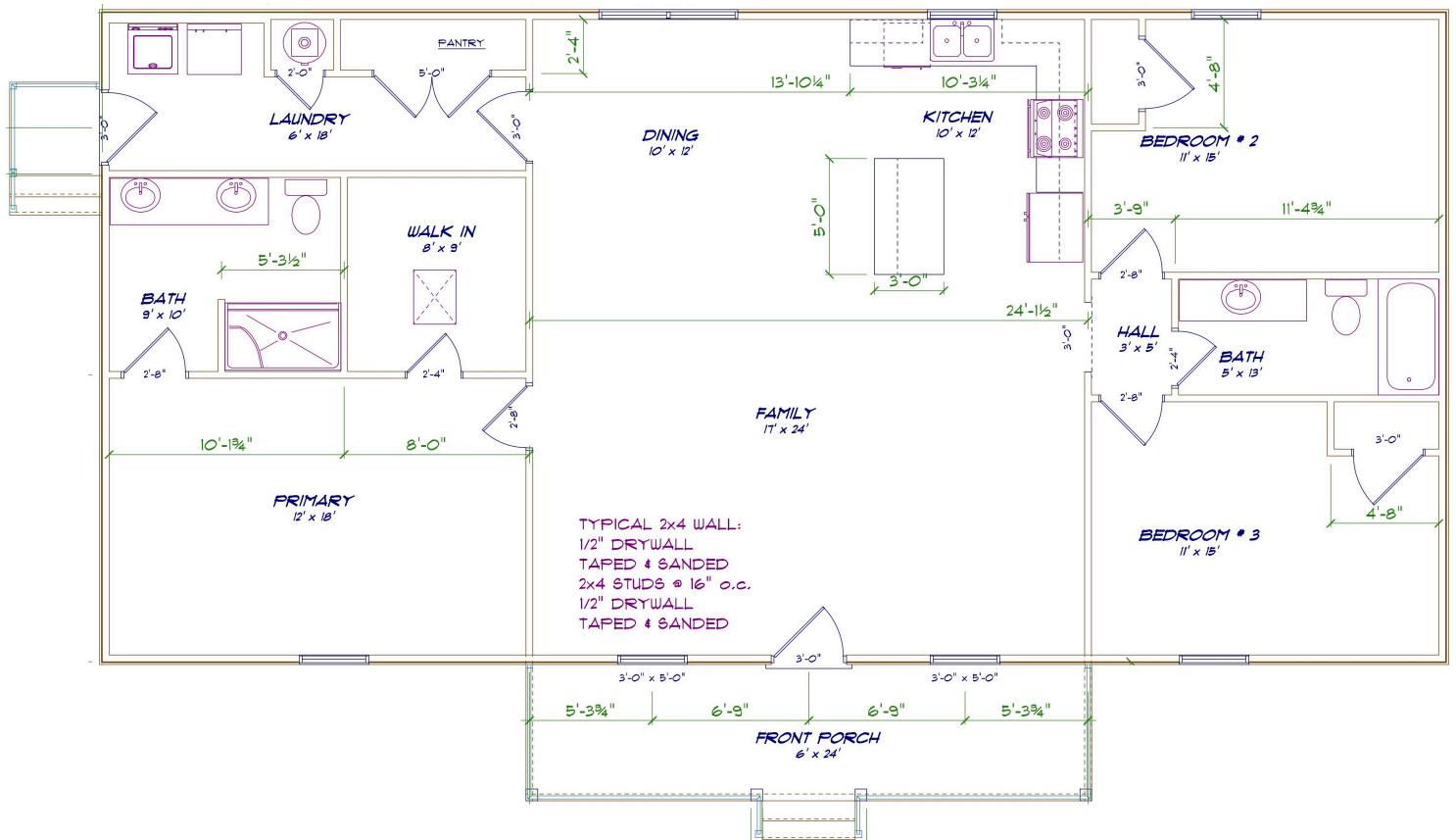

Room dimensions are approximate.
Precise room dimensions provided by a draft for construction.

NAME	SIZE
MAIN FLOOR	1624 Sq Ft +/-
COVERED WOOD PORCH	146 Sq Ft +/-
HOUSE DIMENSIONS	58' x 36'